

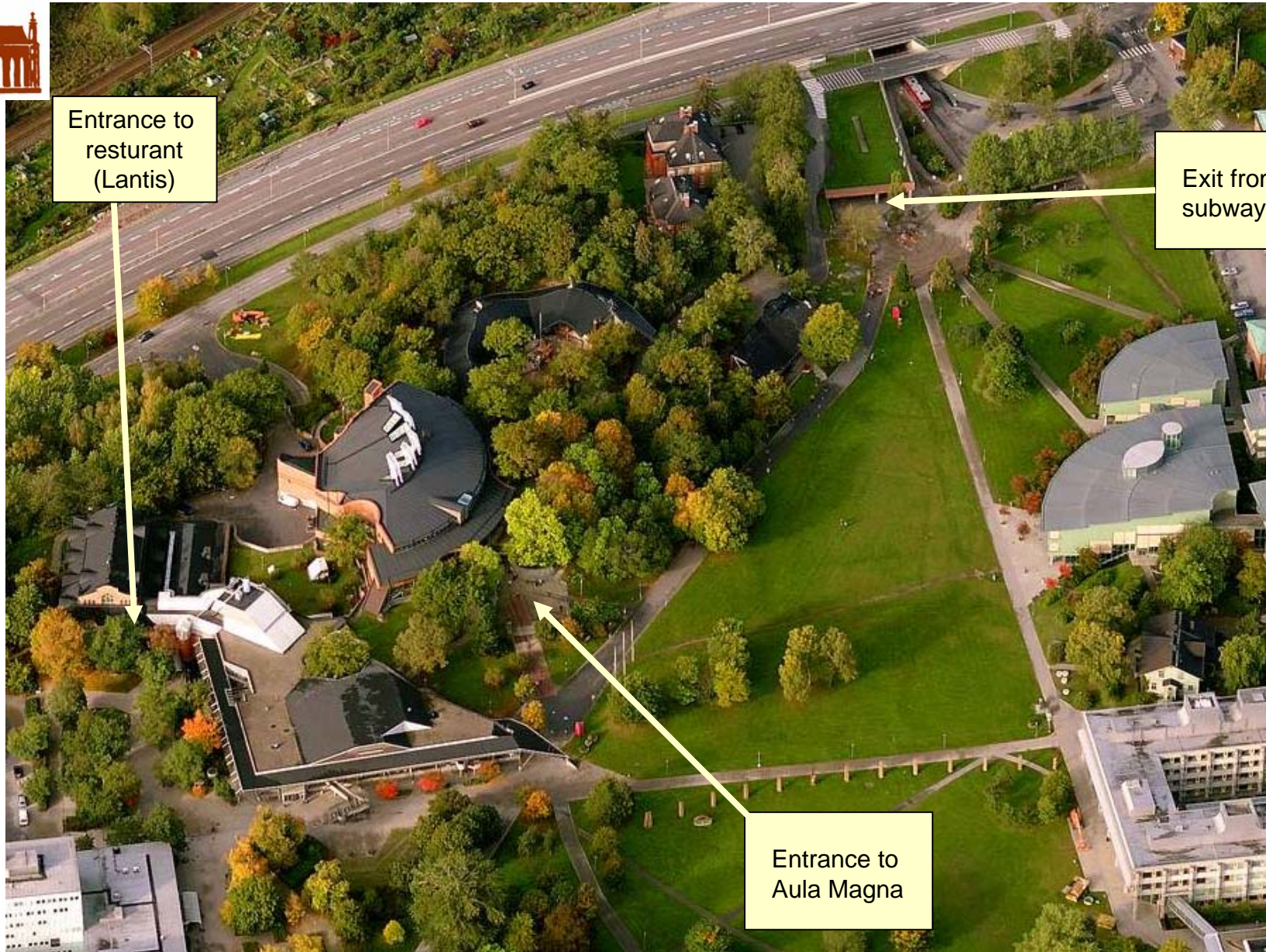

# Conference Venue - Aula Magna of the Stockholm University

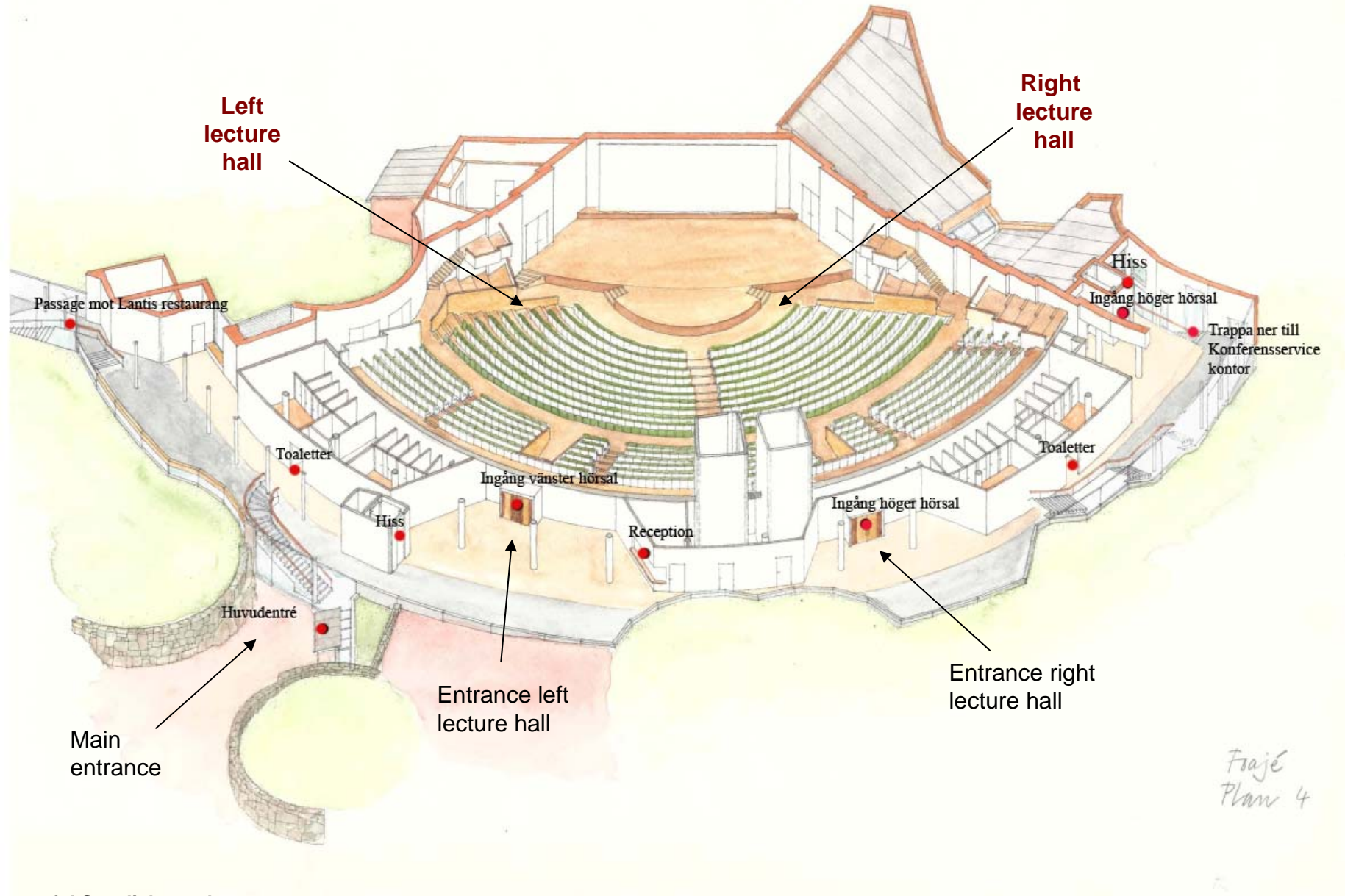

## Aula Magna – level 4 (entrance level)



Some useful Swedish words:

hiss = lift, trappar = stairs, ingång = entrance, utgång = exit, höger = right, vänster = left, hörsal = lecture hall, plan = level, ner = down, upp = up

## Aula Magna – level 5

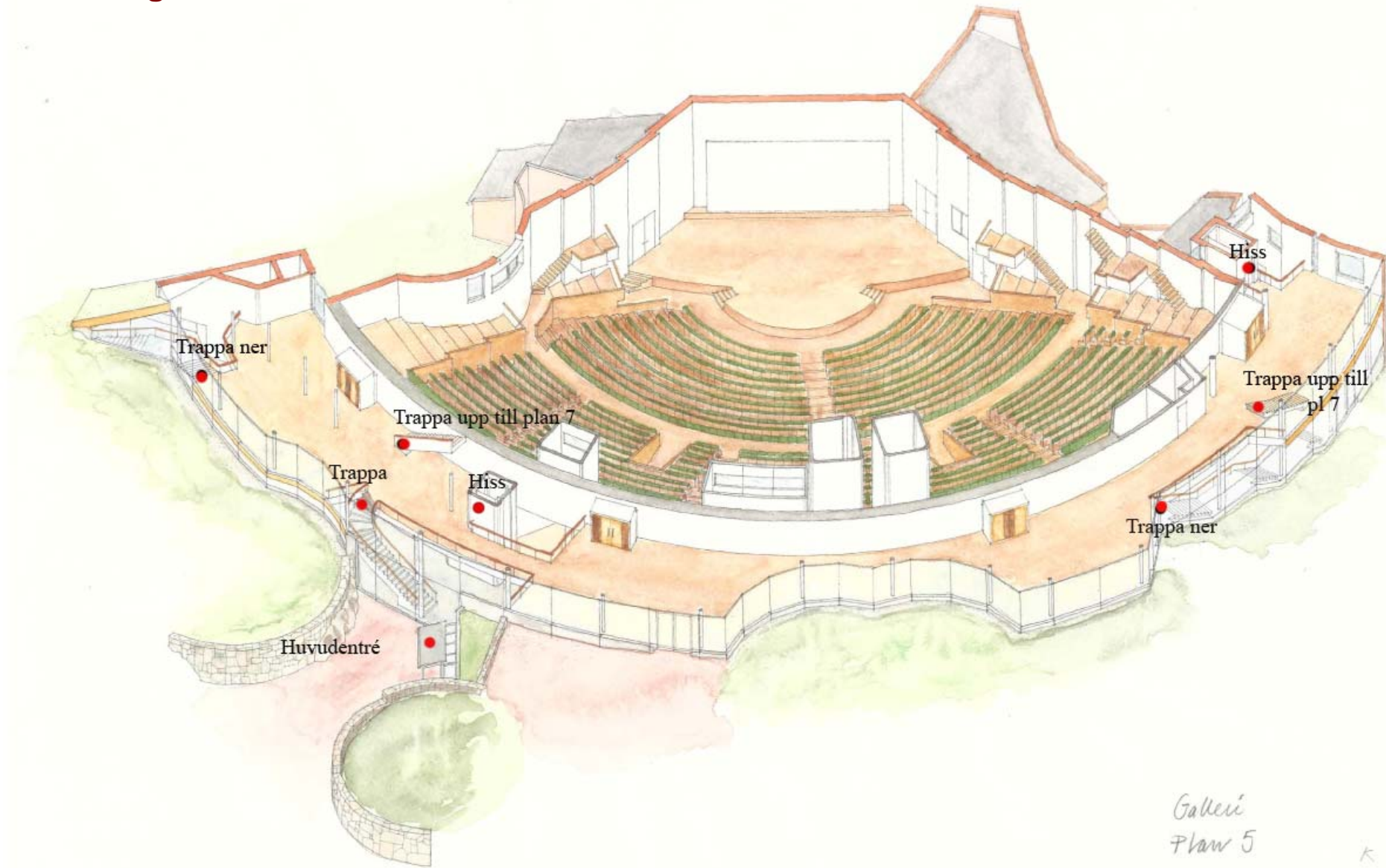

Some useful Swedish words:

hiss = lift, trappor = stairs, ingång = entrance, utgång = exit, höger = right, vänster = left, hörsal = lecture hall, plan = level, ner = down, upp = up

## Aula Magna – level 7 (top level)

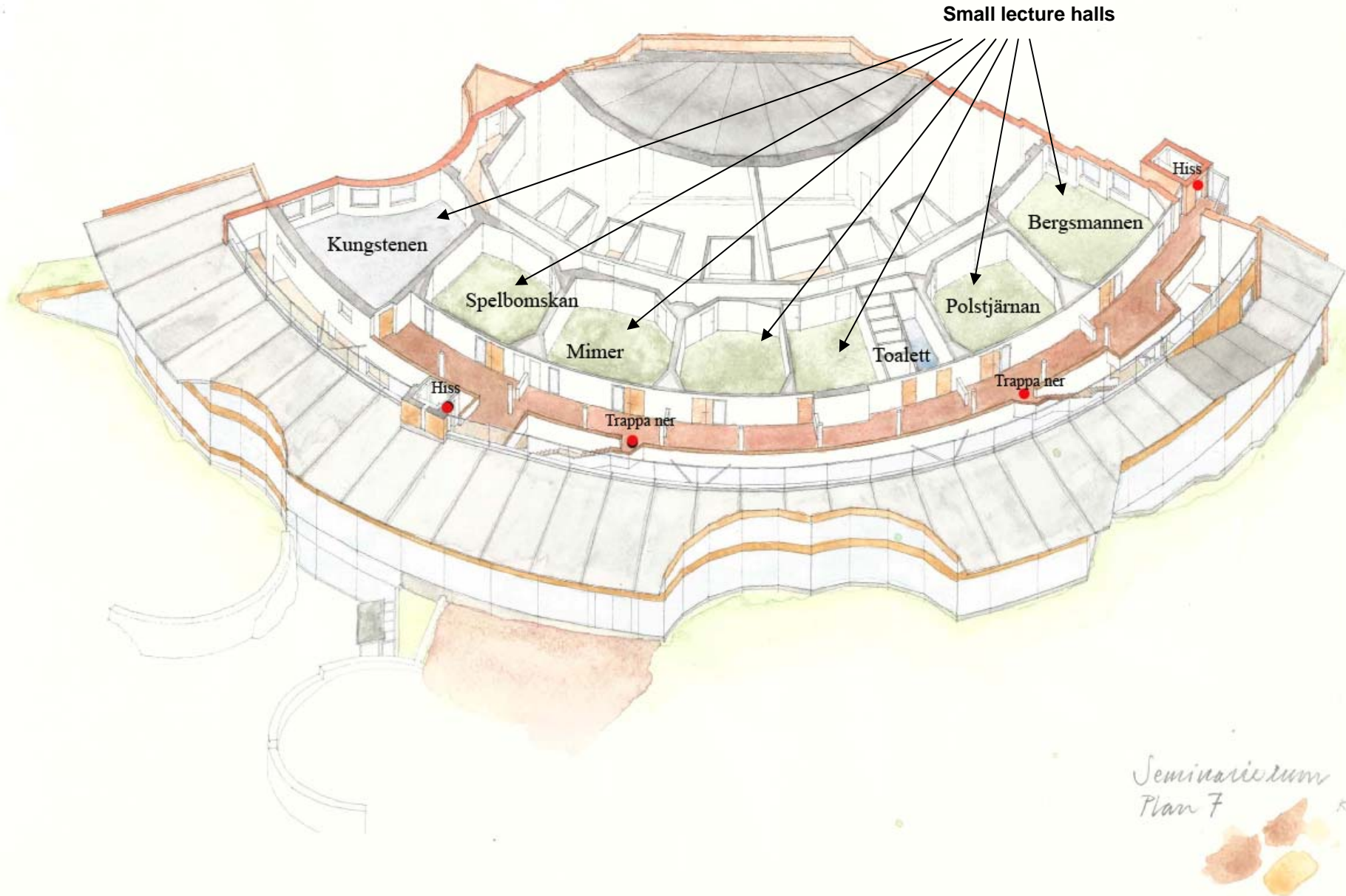

Some useful Swedish words:

hiss = lift, trappor = stairs, ingång = entrance, utgång = exit, höger = right, vänster = left, hörsal = lecture hall, plan = level, ner = down, upp = up